



Town of Greenwich
Department of Parks & Recreation - Facilities
Town Hall – 101 Field Point Road - Greenwich, CT 06836-2540
Phone: (203) 622-7814 - Fax: (203) 622-6494

LOUGHLIN PLAYGROUND

Location: Corner of Loughlin Ave. and Butler St.

Directions from Central Greenwich: U.S. 1 heading towards Stamford, in Cos Cob, you will see a Food Mart Supermarket, Make a right hand turn at the traffic light that is across from it onto Strickland Rd. take first right onto Loughlin Ave. The park will be on your right.

Size: 6.83 Acres

Hr. of Operation: Year round - dawn to dusk
Night Paddle Tennis

Parking: 1. Loughlin Ave. street parking
2. Cross Lane lot - 15 cars

Facilities:

I. Playground Building & Area:

- A. 22' x 38'
- B. Equipment Room
- C. Rest rooms
 - 1. men - 2 urinals, 1 toilet, 1 sink, 1 refuse can
 - 2. women - 2 toilet stalls, 1 sink, 1 refuse can
- D. 1 - Swing Set 25' w/ 6 children's swings (sand base) (good)
- E. 1 - 16' x 24' Basketball court w/ 1 pole, 1 backboard, 1 net, (blacktop, good cond.)

II. Playground Area

- A. Enclosed in 50' x 60' Railroad ties (sand base)
 - 1. 1 - metal and plastic climbing apparatus (22' x 35') w/ 12' sliding board, 1 - 6' twin slide, 1 - 8' tube slide (good)
 - 2. 1 - 8 rung monkey bars (good)
 - 3. 4 - metal spring and plastic rocking horses
- B. Wooden "dock" walk with pylons 15' x 16' (good)
- C. 2 - 8' wood and concrete benches (poor)
- D. 2 - refuse cans, 1 - recycle can

III. Paddle Tennis (fair)

- A. twin courts (raised) 72' x 62' w/ 8 lights

IV. Tennis Courts (good)

- A. 2 - courts-fenced in 100' x 120' w/ 4' gate
- B. wooden equipment shed 4' x 4'
- C. 1 - water fountain

V. Ball Field - Hardball - Softball

A. Dimensions

L.F.- 400'

C.F. -210'

R.F. -230'

B. Equipment L.F. side

1. 1 - 8' metal and plastic players bench (poor)

2. 1 - spectator bleachers - 5 row- 15' metal (good)

C. Equipment R.F. Side

1. 2 - 8' metal and plastic player benches (fair)

2. 1 - spectator bleacher - 5 row - 15' (poor)

D. Backstop

13' x 12' x 13' (fair)

VI. Soccer Field (temp)

A. 300' x 160'

B. 2 goals w/ nets

Loughlin Avenue Playground (6.83 acres)

Loughlin Avenue Playground is situated in central Cos Cob, bordered to the west by Cross Lane and to the East by Loughlin Avenue. Parking is accommodated on Loughlin Ave. and in a 15-car lot on Cross Lane. Stately tall Maples and Sycamores along the parks boundary frame this valuable open space set within a residential area. There is a baseball diamond, soccer field, paddle tennis courts(lighted), tennis courts, swings, and a hard surface basketball area. It is open year round. The Town supervises a variety of summer activities at the playground.

Originally a swampy lowland with a creek or ditch running through its middle, the property was acquired by the Town in 1941 in a tax lien foreclosure. Long-time area residents recall several units of veteran's housing (the quonset variety) constructed on the site by the Town and State for returning World War II servicemen and their families. By the early 1950's, having served their purpose, the huts were removed. Later, tennis courts, brought from behind Cos Cob Firehouse, and playground equipment were added.

Loughlin Playground is enjoyed year round both by area residents and Greenwich residents in general, and the Town is to be commended for its foresight in making excellent use of property it acquired through foreclosure.

Peter Benedict

LOS LOD Playground 6.8 acres
(Loughlin Ave.)

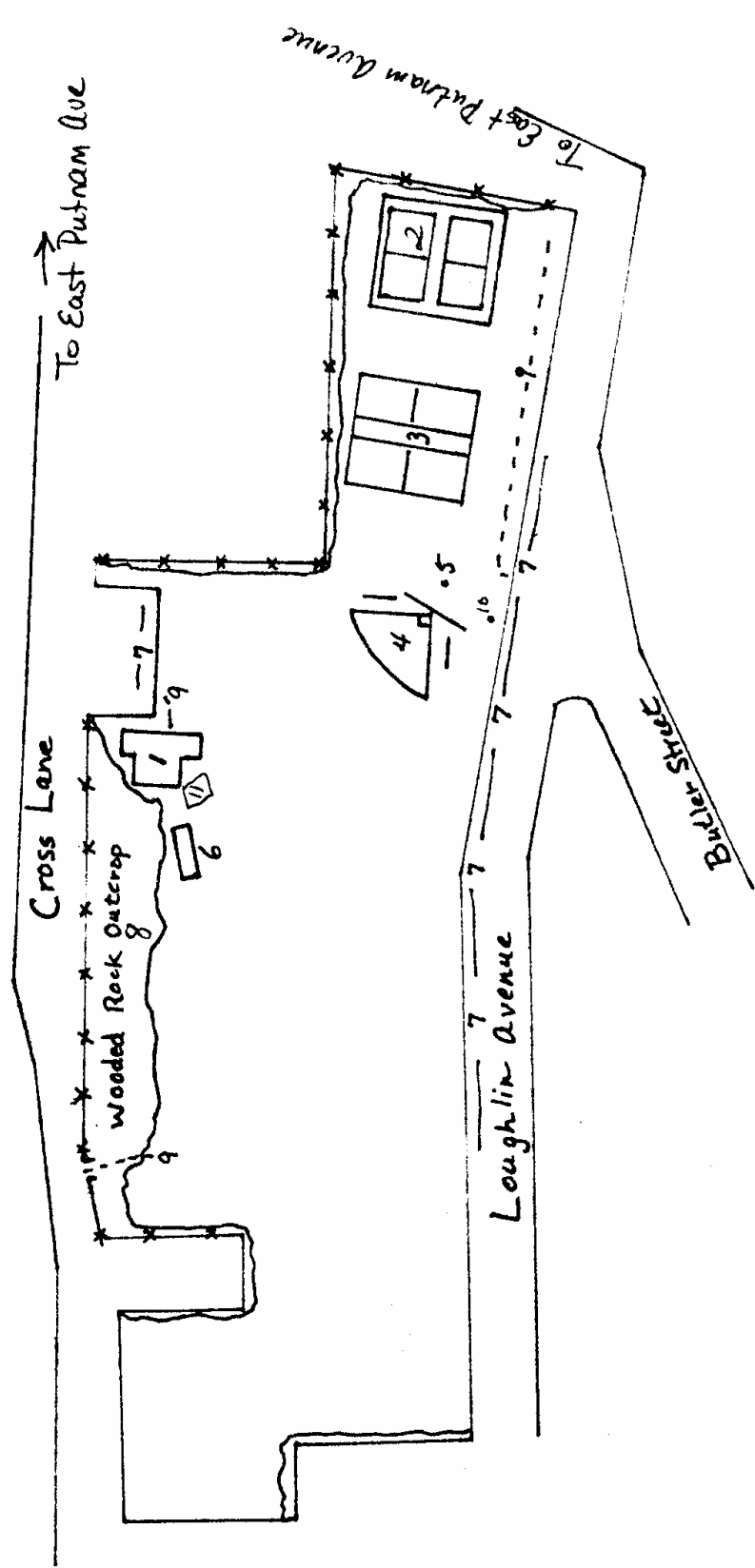

**Loughlin Ave. Playground
Map Key**

1. Community Center w/ rest rooms
2. Tennis Courts (2) w/ nets
3. Paddle Tennis Courts (2) w/ lights and nets
4. Softball & Baseball field w/ back stops & players benches
5. Water fountain (temp)
6. Playground & Swing set(good)
7. Parking
8. Wooded Area
9. Sidewalk or trail
10. 5 hydrants
11. Basketball backboard 16' x 24' hard surface