



**Town of Greenwich**  
**Department of Parks & Recreation - Facilities**  
**Town Hall – 101 Field Point Road - Greenwich, CT 06836-2540**  
**Phone: (203) 622-7814 - Fax: (203) 622-6494**

## **WILLIAM STREET PLAYGROUND**

Location: Corner of Church St. and William St.

Directions:

Size: .926 Acres

Hr. of Operation: Daylight hours year round

Parking: Metered Church St., Non-metered William St.

Facilities:

### I. Open Area: (fair Cond.)

- A. Fenced in 190' x 150'
- B. Blacked top sidewalk - 114' x 5'
- C. 2-6' wood and metal picnic tables
- D. 1 water fountain
- E. 1 refuse can, 1 re-cycle can

### II. Playground Area:

- A. 100' x 120' Fenced in area with 2-4' gates and 1-10' gate
- B. Basketball court (50' x 32') with 1 double pole,  
1 backboard, 1 net (poor cond.), (black top)
- C. 1 16' x 12' climbing apparatus (metal) with 2 sets of 6 steps, 1 sliding board (good), 1- 5 rung climbing ladder (grass base)
- D. 1-10' dia. Metal merry-go-round (grass base) (fair cond.)
- E. 1-38' metal climbing apparatus with circular climbing rings (grass base) (good)
- F. 1-12' metal and plastic sliding board with 6 stairs, enclosed in 24' x 18' railroad ties, (sand base) (good)
- G. 1-28' swing set with 4 bucket swings enclosed in 32' x 16' railroad ties (sand base) (good)
- H. 1-24' swing set with 6 children's swings enclosed in 18' x 42' R.R. ties (sand base) (good)
- I. 1- metal and wood picnic table
- J. 1- Refuse can
- K. 210' x 5' black top sidewalk (fair cond.)
- L. No restroom facilities

## **William Street Playground (1 acre)**

This neighborhood gathering place is located one block north of the Post Road at the Southwest corner of William St. and Church St. The upper area contains playground equipment and the lower flat area is a ball field.

The Parks & Recreation Department supervises competitive games, arts & crafts classes, and beach bus trips. Parents enter in with neighborhood picnics, Flea Market sales, and games for the very young.

This was the site of the first St. Mary's Church, built in 1860. Replaced with a new building on Greenwich Ave. in 1878, the old church was demolished in 1920, and the remains in the cemetery were moved to St. Mary's cemetery on North Street. The Town formally purchased the property in 1953.

Dubbed the Fourth Ward (the only so-called ward in Greenwich) by the Irish families who settled it, the area is still lovingly known that way by old timers.

The playground and ballfield are an asset for the neighborhood youngsters of all ages.

*Melvin F. Doty, Jr.*

William Street Playground 0.9226 acres

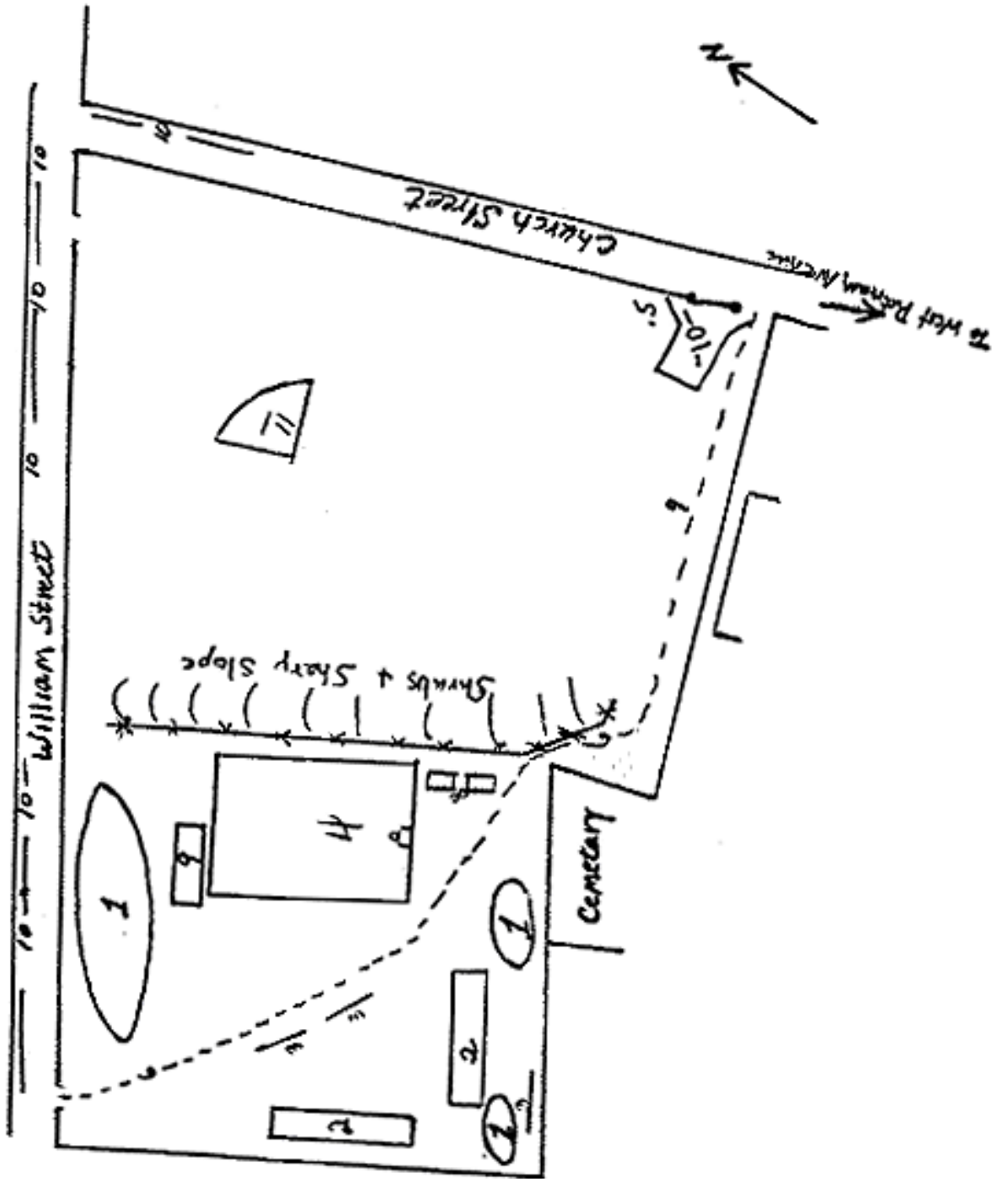

## **William Street Playground Map Key**

1. Children's Playground Area
2. Swings
3. Benches (permanent)
4. Hard surface play area w/ basket 10'
5. Water fountain (temporary)
6. Sidewalk
7. Flagpole
8. Picnic Tables (2-wooden temporary)
9. Equipment Box (wooden temporary)
10. Parking
11. Pee Wee Ball Field